

### GATE FRAME HINGES Without Bolts

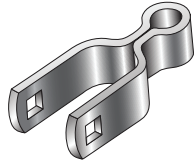

Size	Item#	Sack Qty.	Weight Each	Less Sack Price Each	Sack Price Each
1 3/8" x 1/2"	12521	100	.40 lbs.		
1 3/8" x 5/8"	12522	100	.40 lbs.		
3/8" x 2" bolt & nut required					
1 5/8" x 1/2"	12523	50	.60 lbs.		
1 5/8" x 5/8"	12524	50	.60 lbs.		
1 7/8" x 5/8"	12525	50	.58 lbs.		
3/8" x 2 1/4" bolt & nut required					

### POST HINGES Without Bolts (3/16" x 1 1/4" band)

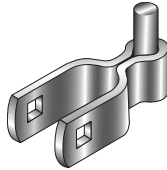

1 3/8" x 1/2"	12621	50	.64 lbs.		
1 3/8" x 5/8"	12622	50	.64 lbs.		
3/8" x 2" bolt & nut required					
1 5/8" x 1/2"	12623	50	.68 lbs.		
1 5/8" x 5/8"	12624	50	.68 lbs.		
1 7/8" x 1/2"	12625	50	.80 lbs.		
1 7/8" x 5/8"	12626	50	.80 lbs.		
3/8" x 2 1/4" bolt & nut required					
2 3/8" x 1/2"	12627	50	.90 lbs.		
2 3/8" x 5/8"	12628	50	.90 lbs.		
3/8" x 3" bolt & nut required					
2 7/8" x 5/8"	12629	50	1.16 lbs.		
3/8" x 3 1/2" bolt & nut required					

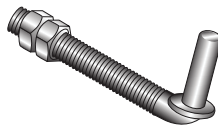

### HINGE HANGER BOLTS

1/2" x 4 1/2"	12801	250	.40 lbs.		
1/2" x 6"	12802	250	.50 lbs.		
5/8" x 4 1/2"	12803	125	.67 lbs.		
5/8" x 6"	12804	100	.87 lbs.		
5/8" x 8"	12805	100	.96 lbs.		
5/8" x 10"	12806	100	1.13 lbs.		
5/8" x 12"	12807	100	1.27 lbs.		

### GATE FRAME HINGES Bolts included

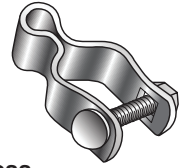

Size	Item#	Sack Qty.	Weight Each	Less Sack Price Each	Sack Price Each
1 3/8" x 1/2"	12501	100	.40 lbs.		
1 3/8" x 5/8"	12502	100	.40 lbs.		
3/8" x 2" bolt & nut included					
1 5/8" x 1/2"	12503	50	.60 lbs.		
1 5/8" x 5/8"	12504	50	.60 lbs.		
1 7/8" x 5/8"	12505	50	.58 lbs.		
3/8" x 2 1/4" bolt & nut included					

### POST HINGES Bolts included (3/16" x 1 1/4" band)

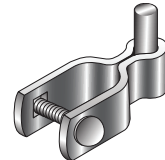

3/8" x 1/2"	12601	50	.64 lbs.		
1 3/8" x 5/8"	12602	50	.64 lbs.		
3/8" x 2" bolt & nut included					
1 5/8" x 1/2"	12603	50	.68 lbs.		
1 5/8" x 5/8"	12604	50	.68 lbs.		
1 7/8" x 1/2"	12605	50	.80 lbs.		
1 7/8" x 5/8"	12606	50	.80 lbs.		
3/8" x 2 1/4" bolt & nut included					
2 3/8" x 1/2"	12607	50	.90 lbs.		
2 3/8" x 5/8"	12608	50	.90 lbs.		
3/8" x 3" bolt & nut included					
2 7/8" x 5/8"	12609	50	1.16 lbs.		
3/8" x 3 1/2" bolt & nut included					

### HINGE HANGER BOLTS, LAG THREAD

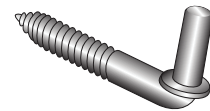

1/2" x 4 1/2"	12821	250	.24 lbs.		
1/2" x 6"	12822	125	.48 lbs.		
5/8" x 4 1/2"	12823	125	.47 lbs.		
5/8" x 6"	12824	125	.56 lbs.		

### AUTO CLOSING HINGE Gravity

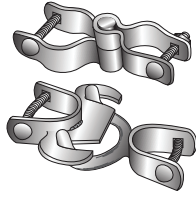

Size	Item#	Sack Qty.	Weight Each	Less Sack Price Each	Sack Price Each
1 7/8" x 1 3/8"	12701	25	3.0 lbs.		
2 3/8" x 1 3/8"	12702	25	3.0 lbs.		
2 3/8" x 1 5/8"	12713	25	3.2 lbs.		
2 7/8" x 1 3/8"	12703	25	3.4 lbs.		
2 7/8" x 1 5/8"	12718	25	3.6 lbs.		
Flat wall x 1 3/8"	12704	25	3.0 lbs.		

### AUTO GATE CLOSER SPRING

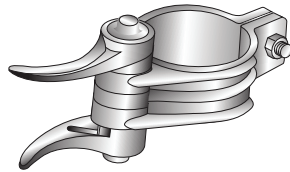

1 3/8" x 1 7/8"	12711	12	.83 lbs.
1 3/8" x 2 3/8"	12712	12	1.0 lbs.

### BULLDOG HINGE Pressed Steel

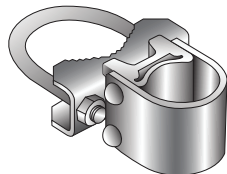

2 3/8" x 1 5/8" or x 1 7/8"	16900	10	3.2 lbs.
2 7/8" x 1 5/8" or x 1 7/8"	16902	10	3.3 lbs.
4" x 1 5/8" or x 1 7/8"	16903	10	3.7 lbs.
4 1/2" x 1 5/8" or x 1 7/8"	16909	10	3.3 lbs.
6 5/8" x 1 5/8" or x 1 7/8"	16906	4	6.0 lbs.
Flat back	16912	10	5.5 lbs.

### ROUND POST HINGE Tension Adjustable, Self-Closing



5" x 4 1/8"	49005	1 pr	2.5 lbs.
-------------	-------	------	----------

For pricing and more information on Tru•Close hinges, see pages 13-14 in Hinges & Latches in the IRON section.

### INDUSTRIAL GATE HINGE Galvanized Iron & Steel

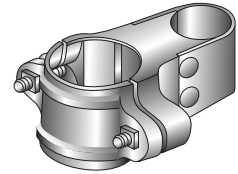

Size	Item#	Sack Qty.	Weight Each	Less Sack Price Each	Sack Price Each
2 3/8" x 1 5/8" or x 1 7/8"	16800	10	5.3 lbs.		
2 7/8" x 1 5/8" or x 1 7/8"	16801	10	5.8 lbs.		
3 1/2" x 1 5/8" or x 1 7/8"	16802	10	6.0 lbs.		
4" x 1 5/8" or x 1 7/8"	16803	10	6.8 lbs.		
6 5/8" x 1 5/8" or x 1 7/8"	16804	4	17.0 lbs.		
8 5/8" x 1 5/8" or x 1 7/8"	16805	4	19.0 lbs.		

### INDUSTRIAL GATE HINGE 180° Attachment

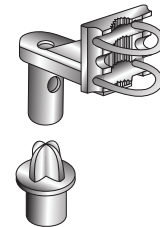

1 5/8" x 1 7/8" adapter	16810	10	6.0 lbs.
1 5/8" ball plug	16813	50	.50 lbs.
1 7/8" ball plug	16814	50	.66 lbs.

### INDUSTRIAL GATE HINGE 180° Galv. Pressed Steel (Fits 1 5/8" or 1 7/8" frame)

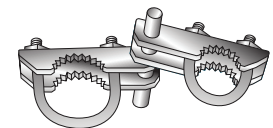

2 3/8"	14101	10	3.6 lbs.
2 7/8"	14102	10	3.6 lbs.
3 1/2"	14103	10	4.0 lbs.
4"	14104	10	4.2 lbs.
4 1/2"	14105	10	4.5 lbs.
6 5/8"	14106	4	7.0 lbs.
8 5/8"	14107	4	1.0 lbs.

### STRAP HINGE For wood gate to pipe post

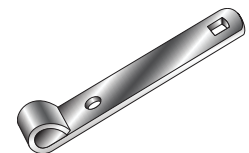

6" x 1/2"	12901	250	.41 lbs.
8" x 5/8"	12902	125	.76 lbs.

### FORK LATCH Galvanized Pressed Steel Includes bolt



Size	Item#	Sack Qty.	Weight Each	Less Sack Price Each	Sack Price Each
1 3/8" x 1 7/8"	13002	25	.92 lbs.		
1 3/8" x 2 3/8"	13003	25	.96 lbs.		
1 3/8" x 2 7/8"	13004	25	1.0 lbs.		
1 5/8" x 1 7/8"	13005	25	1.0 lbs.		
1 5/8" x 2 3/8"	13006	25	1.0 lbs.		
1 5/8" x 2 7/8"	13007	25	1.0 lbs.		
1 5/8" x 4"	13009	25	1.16 lbs.		



### FORK LATCH Galvanized Iron

1 3/8" x 1 3/8"	13101	25	1.44 lbs.
1 3/8" x 1 7/8"	13102	25	1.48 lbs.
1 3/8" x 2 3/8"	13103	25	1.48 lbs.
1 3/8" x 2 7/8"	13104	25	1.52 lbs.
1 3/8" x 3 1/2"	13105	25	1.56 lbs.
1 3/8" x 4"	13106	25	1.60 lbs.
1 5/8" x 1 7/8"	13107	25	1.60 lbs.
1 5/8" x 2 3/8"	13108	25	1.64 lbs.
1 5/8" x 2 7/8"	13109	25	1.68 lbs.
1 5/8" x 3 1/2"	13114	25	1.80 lbs.
1 5/8" x 4"	13110	25	1.16 lbs.
1 7/8" x 1 7/8"	13111	25	1.60 lbs.
1 7/8" x 2 3/8"	13115	25	1.60 lbs.
1 7/8" x 2 7/8"	13112	25	1.64 lbs.
1 7/8" x 3 1/2"	13116	25	1.80 lbs.
1 7/8" x 4"	13113	25	1.96 lbs.



### FORK LATCH Special, Pressed Steel, Galv., assembled with bolts

1 3/8" x 1 3/8"	13021	25	.68 lbs.
1 7/8" x 1 3/8"	13022	25	.84 lbs.
2 3/8" x 1 3/8"	13023	25	.88 lbs.

### FLATBACK FORKLATCH Pressed Steel

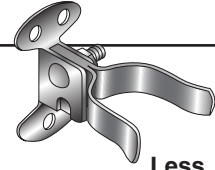

Size	Item#	Sack Qty.	Weight Each	Less Sack Price Each	Sack Price Each
1 3/8" fork	13204	25	.60 lbs.		

### BUTTERFLY LATCH Clamps to gate frame

1 7/8" x 1 3/8"	13301	25	1.0 lbs.
2 3/8" x 1 3/8"	13302	25	1.0 lbs.
2 3/8" x 1 5/8"	13302-10	25	1.2 lbs.

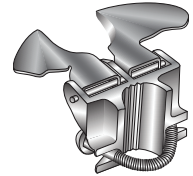

### BUTTERFLY LATCH Flat back for wood post

1 3/8"	13321	25	1.0 lbs.
--------	-------	----	----------



### SPRING LATCH Pressed Steel (without bolts)

1 3/8" frame	13501	25	.80 lbs.
--------------	-------	----	----------

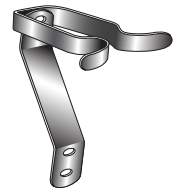

### GATE LATCH - Uni•Latch Round Frame

UL-101	15991	10	2.2 lbs.
<b>Weld-on</b>			
UL-104	15997	10	2.2 lbs.
<b>Bolt-on</b>			

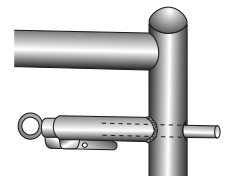

### LATCH CATCH Pressed Steel (without bolt)

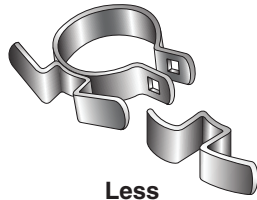

Size	Item#	Sack Qty.	Weight Each	Less Sack Price Each	Sack Price Each
1 7/8" O.D.	13604	250	.34 lbs.		
2 3/8" O.D.	13605	250	.36 lbs.		
Universal	13606	250	.17 lbs.		

### LATCH ASSEMBLY Residential Double Drive (1 3/8" frame)

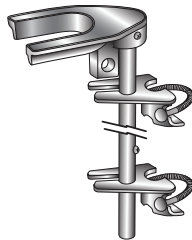

1 3/8" x 36"	13701	10	3.1 lbs.		
1 3/8" x 48"	13702	10	3.5 lbs.		
Guide w/bolt	13703	20	.35 lbs.		

### DROP RODS - Galvanized (guides not included)

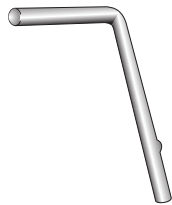

1/2" x 36"	13802	25	2.20 lbs.		
1/2" x 44"	13803	25	2.52 lbs.		

### LATCH ASSEMBLY Industrial Double Gate

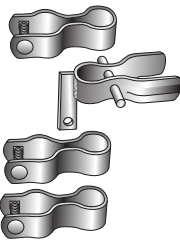

Fork w/3 guides & bolts:		(Drop rod not included)			
1 5/8"	14201	5	4.80 lbs.		
1 7/8"	14202	5	4.98 lbs.		
Fork only	14221	5	1.56 lbs.		
Guides only: 1 5/8"	14241	15	2.88 lbs.		
Guides only: 1 7/8"	14242	15	3.16 lbs.		

### ROLO LATCH For Rolling Gates (without bands)

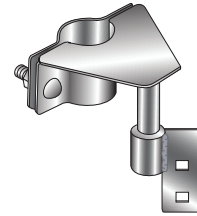

Size	Item#	Sack Qty.	Weight Each	Less Sack Price Each	Sack Price Each
1 5/8" - 1 7/8"	13303	10	2.5 lbs.		

### LOCK-N-LATCH

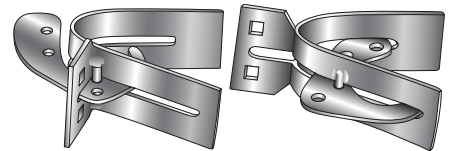

Off-Set	13305	10	1.5 lbs.		
Regular	13306	10	1.5 lbs.		

### FROST FREE GATE LATCH

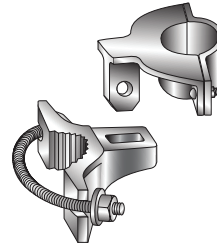

1 5/8"	13319	10	2.8 lbs.		
1 7/8"	13320	10	3.0 lbs.		

### GATE HOLDBACK Galvanized Iron

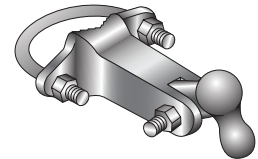

1 5/8" or 1 7/8"	14302	5	2.6 lbs.		
------------------	-------	---	----------	--	--

### GATE HOLDBACK Pressed Steel

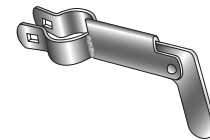

1 5/8"	14305	20	1.0 lbs.		
--------	-------	----	----------	--	--

### CENTER STOP Galvanized Iron



7 1/8" diameter	14245	5	3.6 lbs.		
-----------------	-------	---	----------	--	--

### SAFETY PIPE TRACK WHEELS

#### PRESSED STEEL

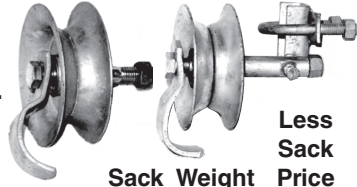

Size	Item#	Sack Qty.	Weight Each	Less Sack Price Each	Sack Price Each
5" wheel	14800	10	2.9 lbs.		
5" w/clamp on brkt	14805	4	4.5 lbs.		
7" w/clamp on brkt	14780	4	6.3 lbs.		

#### PRESSED STEEL with Delrin Bushing

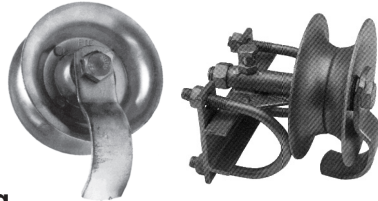

5"	14800-DEL	10	2.3 lbs.		
5" *	14805-DEL	10	5.0 lbs.		

\* W/Clamp-on double bracket

#### GALVANIZED IRON

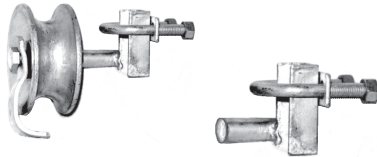

5" w/clamp-on brkt	14811	4	6.0 lbs.		
Industrial gate roller bracket only	14812	10	1.6 lbs.		

#### GALVANIZED IRON with double bracket & Delrin Bushing

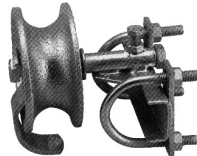

5"	14811-DEL	10	5.3 lbs.		
----	-----------	----	----------	--	--

Pipe track roller includes the double bracket and is sold as a unit

#### DOUBLE BRACKET ONLY

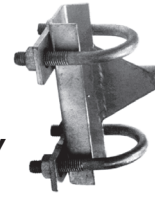

Size	Item#	Sack Qty.	Weight Each	Less Sack Price Each	Sack Price Each
Universal	14812-DEL	10	2.6 lbs.		

#### CLAMP ON BRACKET Pressed Steel

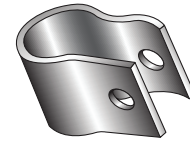

1 5/8"	14802	25	.44 lbs.		
1 7/8"	14806	25	.52 lbs.		

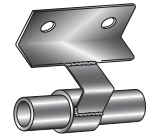
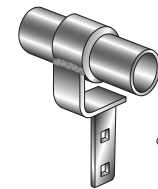
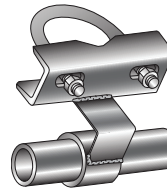

#### SAFETY TRACK BRACKETS With U-bolts

1 7/8" or 1 5/8"	14910	20	2.6 lbs.		
2 7/8" or 2 3/8"	14912	20	2.7 lbs.		
4"	14916	20	2.8 lbs.		
Flat wall	14913	20	1.9 lbs.		
Band type	14914	20	1.2 lbs.		

#### CHANNEL TRACK WHEEL Galvanized Iron

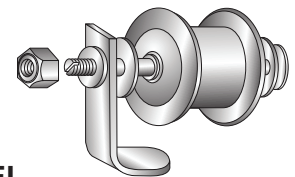

3 1/2"	14804	6	3.0 lbs.		
--------	-------	---	----------	--	--



### HEAVY DUTY PLASTIC 1 5/8" Pipe Track Wheel

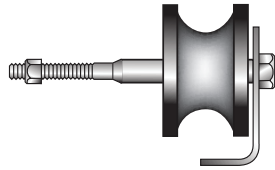

Size	Item#	Sack Qty.	Weight Each	Less Sack Price Each	Sack Price Each
4" Plastic wheel	14711-20	4	3.0 lbs.		

- Wheel is maintenance free and will not split apart, rated for 350 lbs.

### GROUND WHEEL Ball Bearing (P. S. Hub)

6" x 5/8"	14702	6	2.0 lbs.
8" x 5/8"	14704	6	3.0 lbs.

Includes Axle



### EVERLAST RUBBER WHEEL

6" x 5/8" axle	14752	5	3.6 lbs.
8" x 5/8" axle	14754	5	4.0 lbs.

- Tested to exceed 5,000 lbs. — 2" tire width



### V-GROOVE NYLON WHEEL

4" Diameter	14692	4	1.25 lbs.
-------------	-------	---	-----------

- Recommended on light weight gates for quiet operation
- 1/2" diameter axle with lubricated brass bushing — \* SEE IRON SECTION FOR PRICE —

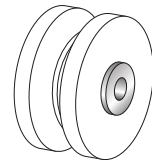

### V-GROOVE IRON WHEEL

With Steel Roller Bearing — Includes Axle

4" dia 1 1/2" w	14718	4	5.0 lbs.
4" dia 2 1/2" w	14705	4	5.0 lbs.
6" dia 2 1/2" w	14706	4	7.0 lbs.

Above with 1/2" axle

◇ 8" dia 3 1/4" w	14707	4	9.5 lbs.
-------------------	-------	---	----------

◇ ( 1" axle not included )

6" dia 2 1/2" w	14706-DEL	4	6.8 lbs.
-----------------	-----------	---	----------

With Delrin bushing — Tested to exceed 3,500 lbs.  
Includes 5/8" axle



### V-GROOVE WHEEL Solid Steel

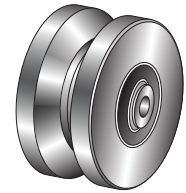

Size	Item#	Sack Qty.	Weight Each	Less Sack Price Each	Sack Price Each
6" Solid Steel wheel	14706-10	4			
<b>4,000 lb. capacity each wheel</b>					
6" Solid S. power wheel	14706-EL	4			
<b>5,000 lb. capacity each wheel</b>					
4" Solid S. power wheel	14705-10	4			
<b>3,000 lb. capacity each wheel</b>					

SEE IRON  
ROLLING GATE HARDWARE

Solid Steel wheels are designed to be maintenance free on continuous applications.

- 4" wheel includes two - 2" sealed bearings with 1" axle and one 1/2" x 3.25" bolt with nut.
- 6" wheel includes two - 2.5" sealed bearings with 1.18" axle and one 5/8" x 3.25" bolt with nut.

### SINGLE WHEEL CARRIER

Weld on type - 2 piece

1 5/8" w6" wheel	14401	5	5.8 lbs.
1 7/8" w6" wheel	14411	5	6.0 lbs.
1 5/8" w8" wheel	14421	5	7.0 lbs.
1 7/8" w8" wheel	14431	5	7.2 lbs.

Includes Axle



### CARRIERS ONLY

No Wheels - 2 piece

1 5/8" w6" wheel	14441	5	3.0 lbs.
1 5/8" w8" wheel	14442	5	3.0 lbs.
1 7/8" w6" wheel	14451	5	3.0 lbs.
1 7/8" w8" wheel	14452	5	3.0 lbs.



# BFC

## Carriers / Cantilever Rollers

### DOUBLE WHEEL CARRIERS

( Light )  
Clamp-on for 1 5/8 or 1 7/8



Size	Item#	Sack Qty.	Weight Each	Less Sack Price Each	Sack Price Each
W/6" wheels	14641	4	7 lbs.		

( Regular )  
Clamp-on for 1 5/8 or 1 7/8



6" wheels	14601	5	9 lbs.		
8" wheels	14602	5	12 lbs.		

( Heavy Duty )  
Clamp-on for 1 5/8 or 1 7/8

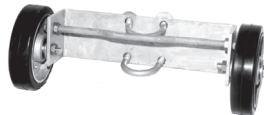

6" wheels	14621	1	11 lbs.		
8" wheels	14622	1	12 lbs.		

Rough Terrain  
Clamp-on for 1 5/8 or 1 7/8

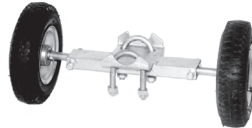

W/8" wheels (Pneumatic)	14600	1	15 lbs.		
----------------------------	-------	---	---------	--	--

V-Groove / Rubber Wheel  
Clamp-on for 1 5/8 or 1 7/8



6" wheels	14624	1	12 lbs.		
-----------	-------	---	---------	--	--

SWIVEL WHEELS  
For Swing Gates



1 3/8"	14654	4	4.6 lbs.		
1 5/8"	14655	4	4.7 lbs.		
1 7/8"	14656	4	4.8 lbs.		
Flatback	14657	4	5.0 lbs.		

### CANTILEVER ROLLERS & COVERS

- Wheel covers required for all cantilever wheels.  
— Sold separately —



Galvanized Iron

Size	Item#	Sack Qty.	Weight Each	Less Sack Price Each	Sack Price Each
Post x Roller					
2 7/8" x 1 7/8"	14712	8	14 lbs.		
2 7/8" x 2 3/8"	14710	8	15 lbs.		
4" x 1 7/8"	14713	8	17 lbs.		
4" x 2 3/8"	14711	8	19 lbs.		

Nylon Rollers



Round Post x Roller

4" x 2 3/8"	14711-15F	8	10 lbs.		
6 5/8" x 2 3/8"	14716-10F	8	18 lbs.		
4" x 2 3/8"	14711-15	8	10 lbs.		

Domestic

Cantilever Roller Covers



14722-10F



14722-10H

PolyPlastic 14722-10F 28 1.5 lbs.  
Fits 14711-15F above

Plastic Cover 14722-10H 16 1.5 lbs.  
With pressed steel bracket

Fits 14716-10F and 14711-15, and 2 7/8" & 4" galvanized iron wheels

© 2012 BUILDERS FENCE CO., INC.

PRICES SUBJECT TO CHANGE WITHOUT NOTICE

8530 UNSWORTH AVE.  
SACRAMENTO, CA 95828-1009  
1-916-381-4065

13111 DAHLIA ST.  
FONTANA, CA 92337-6902  
1-909-350-9040

8937 SAN FERNANDO RD.  
SUN VALLEY, CA 91352-1410  
1-818-504-3700

1265 N. CUYAMACA ST.  
EL CAJON, CA 92020-1549  
1-619-449-0333

10010 PORTLAND AVE.  
TACOMA, WA 98445-3956  
1-253-535-5500

# BFC

## Gate Rods, Scrolls & Clamps

### GATE RODS 5/16" Round Galvanized

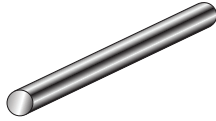

Fence Height	Actual Length	Item#	Bu. Qty.	Weight Each	Price Each	
					Less Bundle	Bundle
3'	32"	10401	25	.65 lbs.		
3 1/2'	38"	10402	25	.74 lbs.		
4'	44"	10403	25	.91 lbs.		
5'	56"	10404	25	1.17 lbs.		
6'	68"	10405	25	1.43 lbs.		

### GATE SCROLL Three Piece Steel



Size	Item#	Sack Qty.	Weight Each	Less Sack Price Each	
				Sack Price Each	Sack Price Each
18"	13901	10	1.1 lbs.		
24"	13902	10	1.4 lbs.		
36"	13903	10	1.7 lbs.		
48"	13904	10	1.9 lbs.		

### GATE SCROLL Aluminum

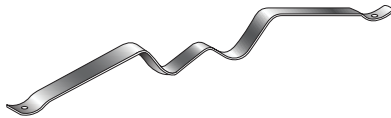

18"	13911	25	.27 lbs.
24"	13912	25	.33 lbs.
36"	13913	25	.44 lbs.
48"	13914	25	.50 lbs.

### GATE CLIPS



1 3/8" x 5/8"	14001	500	.11 lbs.
1 3/8" x 5/8" c-style	14001-C	500	.11 lbs.
1 5/8" x 3/4"	14003	250	.16 lbs.

### CORNER GATE ELLS Die Cast Aluminum

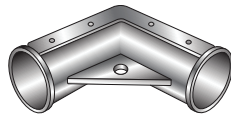

1 3/8" hexagon	16750	100	.48 lbs.
----------------	-------	-----	----------

### CORNER GATE ELLS Pressed Steel

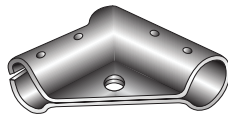

1 5/8"	16760	50	2.5 lbs.
1 7/8"	16761	25	2.5 lbs.

### LINE RAIL CLAMP Pressed Steel without Bolts



Size Post & Rail	Item#	Sack Qty.	Weight Each	Less Sack Price Each	Sack Price Each
1 7/8" x 1 3/8" 5/16" x 2" bolt & nut required	13410	100	.72 lbs.		
1 7/8" x 1 5/8"	13411	100	.73 lbs.		
2 3/8" x 1 5/8"	13415	100	.80 lbs.		
2 7/8" x 1 5/8" 5/16" x 2 1/2" bolt & nut required	13416	50	1.0 lbs.		

#### ORDER SEPARATELY

### SADDLE CLAMP Pressed Steel without Bolts



1 3/8" x 1 3/8" 3/8" x 1 1/4" carriage bolt & nut required	16796	100	.67 lbs.
1 5/8" x 1 5/8"	16797	100	.67 lbs.
1 7/8" x 1 7/8" 3/8" x 1 1/4" carriage bolt & nut required	16798	100	.76 lbs.

#### ORDER SEPARATELY

#### ORDER SEPARATELY

### PANEL CLAMP Pressed Steel without Bolts

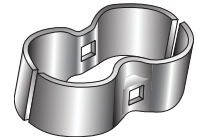

1 3/8" x 1 3/8" 3/8" x 2 1/4" bolt & nut required	13401	100	.50 lbs.
1 5/8" x 1 5/8" 3/8" x 2 1/2" bolt & nut required	13402	100	.72 lbs.

#### ORDER SEPARATELY

#### ORDER SEPARATELY

1 7/8" x 1 7/8" 3/8" x 3" bolt & nut required	13403	100	.80 lbs.
---	-------	-----	----------

#### ORDER SEPARATELY

### GATE BRACE CLAMP Pressed Steel without Bolts

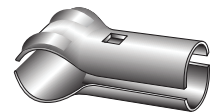

1 3/8" x 1 3/8"	16790	100	.32 lbs.
1 5/8" x 1 5/8"	16791	100	.50 lbs.
1 7/8" x 1 7/8" 5/16" x 2 1/2" bolt & nut required	16792	100	.35 lbs.

#### ORDER SEPARATELY

© 2011 BUILDERS FENCE CO., INC.

PRICES SUBJECT TO CHANGE WITHOUT NOTICE

8530 UNSWORTH AVE.  
SACRAMENTO, CA 95828-1009  
1-916-381-4065

13111 DAHLIA ST.  
FONTANA, CA 92337-6902  
1-909-350-9040

8937 SAN FERNANDO RD.  
SUN VALLEY, CA 91352-1410  
1-818-504-3700

1265 N. CUYAMACA ST.  
EL CAJON, CA 92020-1549  
1-619-449-0333

10010 PORTLAND AVE.  
TACOMA, WA 98445-3956  
1-253-535-5500